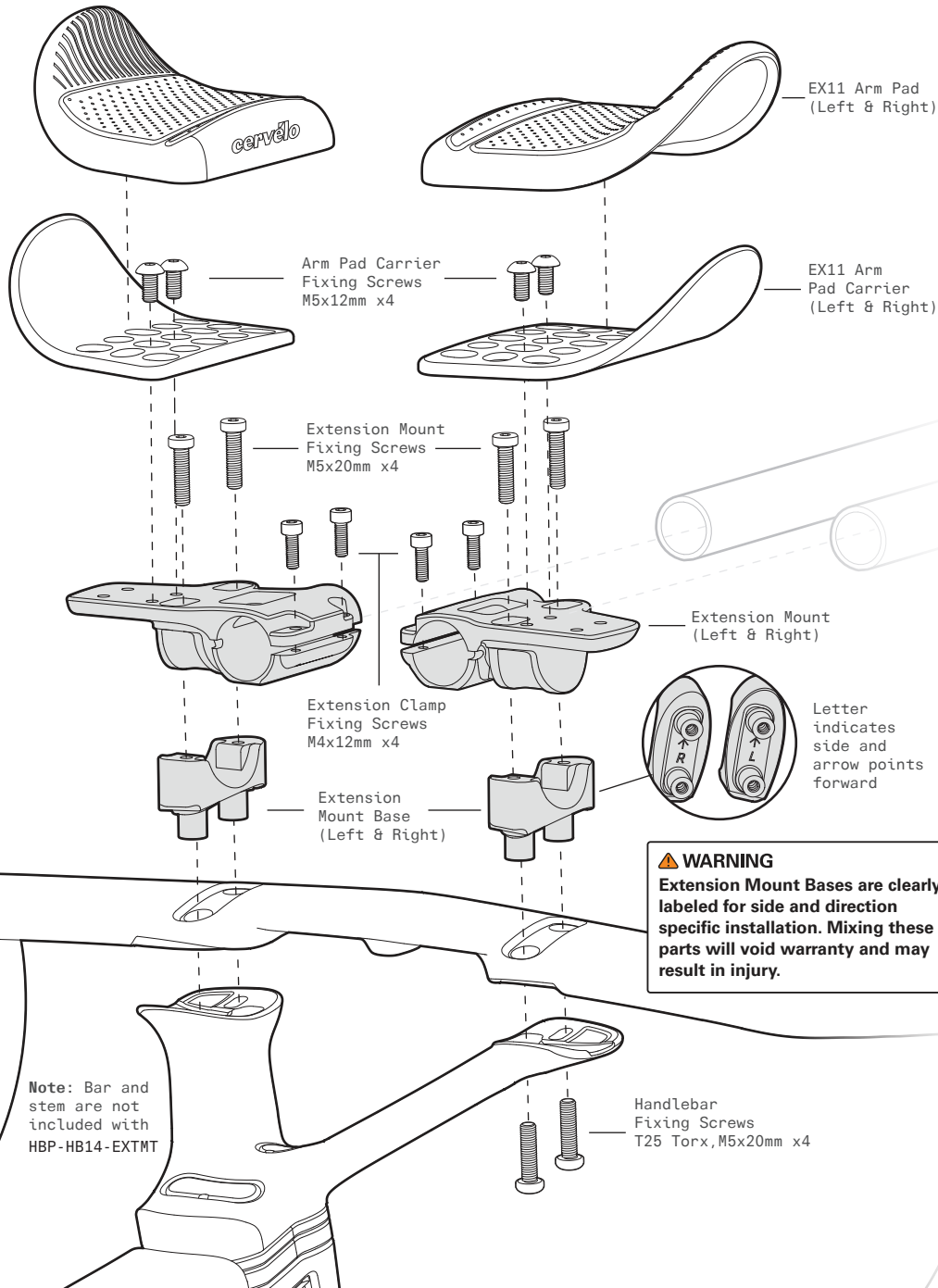

HB14-EXTMT

cervélo

HB14 Tri Extension
Mount Assembly

HB14 TRI EXTENSION MOUNT ASSEMBLY

HBP-HB14-EXTMT



ADJUSTING PAD POSITION

Use the Arm Pad Carrier Fixing Screws to adjust position of the Arm Pad Carriers.

Once desired position is found, torque the screws to 3Nm.

The fixing screws must be installed in fore-aft fixing position, and not in a diagonal.

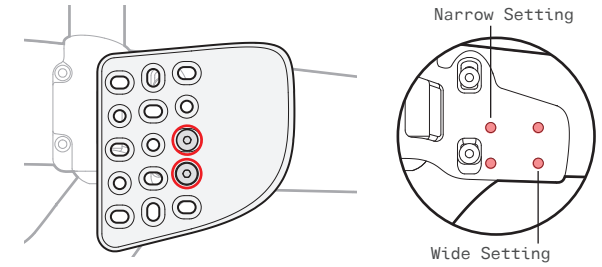

TILT ADJUSTMENT

Use the Extension Mount Fixing Screws to adjust the angle of the extensions and pads from 0°-15°.

Once desired angle is found, torque the screws to 3Nm.

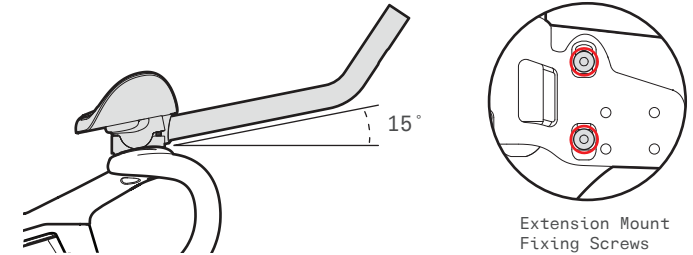

EXTENSION POSITIONING

Secure the extensions by tightening Extension Clamp Fixing Screws to 3Nm.

Ensure that the rearward end of the extensions is set flush or less than 5mm from the rearward edge of the Extension Mount as shown.

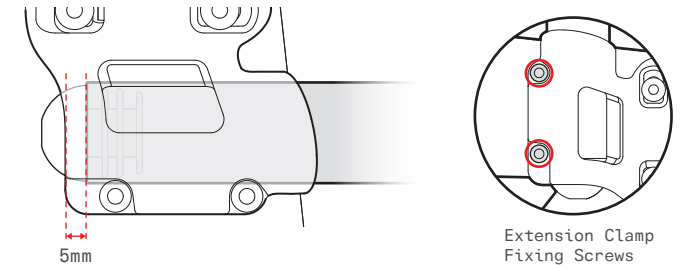

E-WIRE ROUTING

If extension shifters are used, route E-wire through the back of the extension and into the slot on the back of the Extension Mount Base.

Tuck E-wire into slot on Extension Mount.

Tuck E-wire into rear lower slot on Extension Mount Base.

